

# User Manual

---

**Model:** NG-C7100

Version: 1.0

English

# Table of Contents

What's in the Box	2
Installation Drawing	3
Dimensions	4
Connecting to NGTeco Home App	5
Main Function Introduction	10
FAQ	19
FCC	20

# What's in the Box



Floodlight Camera X1



Round Head with  
Phillips Machine Screw X1



Silicone Gasket X1



Screw X2



Hanging Board X1



Spring Screw Terminal X3

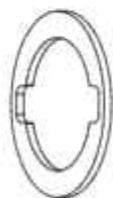

Sponge Mat X1



Terminal Block X1



Ziplock Bag X1



User Manual X1

# Installation Drawing

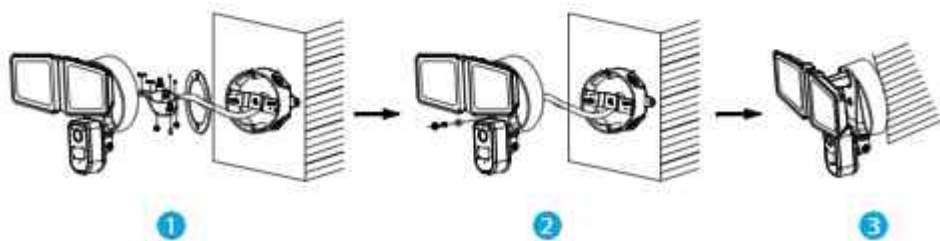
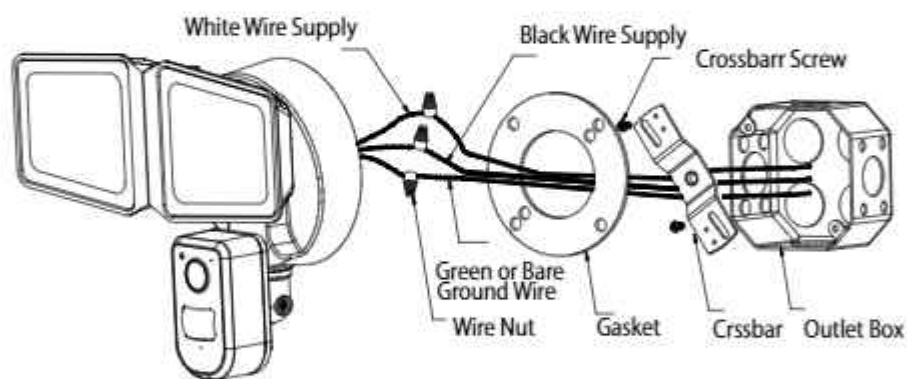
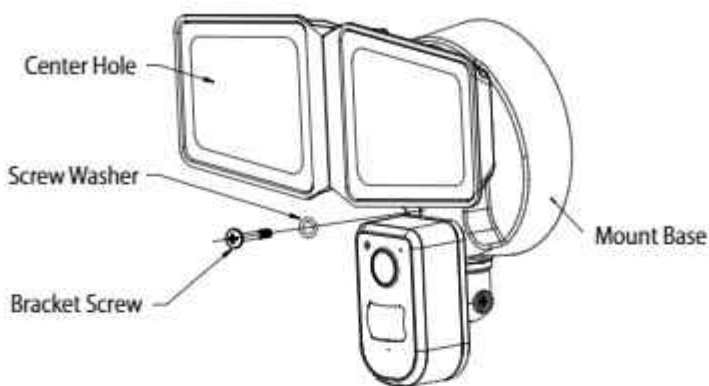

## Dimensions (Unit: inch)

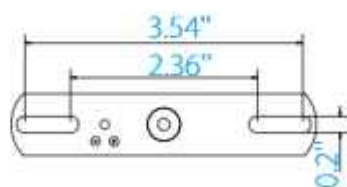
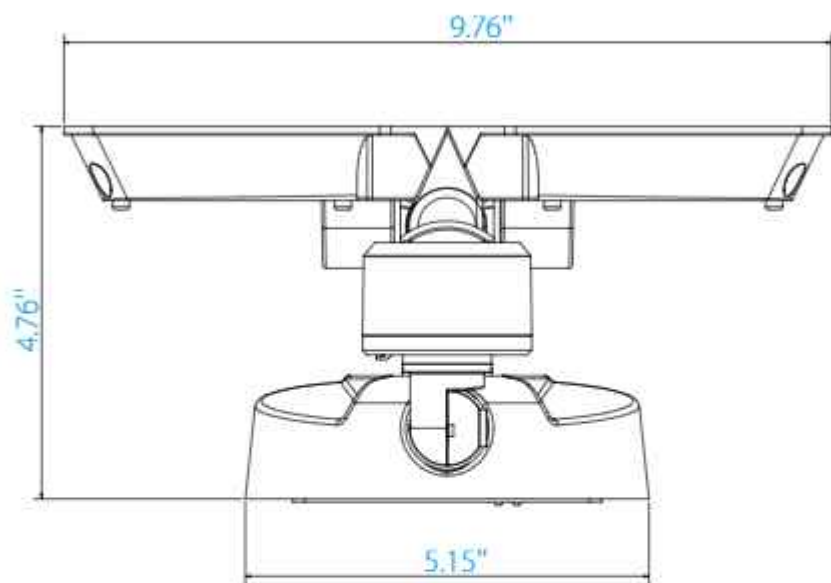

# Connecting to NGTeco Home App

## 1. Download NGTeco Home APP:

### Step 1: Download the App and Register Your Account

Search for the NGTeco Home App in Apple App Store or Google Play Store and download the App to your mobile phone. Open the NGTeco Home App and log in with your account. If you do not have an account, create an account with your phone number or Email ID.



### Step 2: Adding Equipment

Open the APP and click the "+" button on the home page to enter the device selection page. Select the smart camera and complete the device addition according to the instructions.

#### Note:

The camera only supports the 802.11a/b/g/n 2.4G/5G WiFi protocol. Please keep your phone and router connected through WiFi, and download and install the app (both apps are available).

## 2. User Registration and Login:

- Open the app, If you do not have an account, click "create a new account" (Figure 1) to see the Aikeri Smart platform's privacy policy. Click "I Agree" and enter your mobile phone number or email address to create an account.
- After registration, log in to the system. You can choose a password login or a verification code to log in.
- After logging in, you can either add a device directly or create a home and then add it.  
**How to Create a Family:** Click "Me" in the lower right corner of the app, select "family management" "my home", fill in the information and save it.



1



2



3

### 3. Add Device:

As shown in the figure, click "add device" or "+" on the top right of the app home page to manually add devices and search for devices in the LAN. Choose from the following options: Security & Video Surveillance → Smart Camera / Floodlight Light.



1



2

The app offers following two distribution modes:

- Wi-Fi Mode (Figure 1)
- QR Code Mode (Figure 2)

The default mode is the QR code mode. To change the distribution mode, click "other distribution networks" in the top right corner of the "QR code mode" home page.



1



2

#### 4. Network Distribution Mode 1 (Wi-Fi Mode):

When using WiFi to quickly connect to the distribution network, first verify that the intelligent device's indicator light (red and blue flashing) is in distribution network mode (after the first distribution network or reset, turn on the device and hear the beep sound). Select Wi-Fi Mode (Figure 1), then click "EZ Mode" (Figure 2), enter your WiFi password (Figure 3), and click OK to access the distribution network interface (Figure 4) Wait for the application to display the connection success interface, then click Finish (Figure 5); indicating that the device has been successfully added.



1



2



3





4



5

\* After the distribution network is successful, you can modify the equipment's name or select the room's location.

## 5. Network Distribution Mode 2 (QR code):

To configure the network using the QR code, first verify that the intelligent device indicator light (flashing red and blue) is in the distribution mode (after the initial distribution or reset, power on the device and hear the beep sound). To proceed to next step, click the button (Figure 1), input the WiFi password (Figure 2), click OK, and the QR code distribution guidance interface will appear (Figure 3). Continue to display a QR code by clicking the button. With the device, scan the QR code on the mobile phone. When the device makes a long beep sound, click the button to proceed to the next step and enter the distribution network interface (Figure 4). Wait for the connection success interfaces to appear in the application. Click Finish (Figure 5) to add the device successfully.



1



2



3



4



5

\* After the distribution network is successful, you can modify the equipment's name or select the room's location.

# Main Function Introduction

## 1. View Real-time Video and Main Interface Functions:

To enter the camera's control panel, click the device (Figure 1). The interface shows the live broadcast picture, which can be switched between HD and SD and played in full screen mode. The bottom menu provides settings such as full screen viewing, taking a picture, intercom, video recording, video playback, picture direction, alarm, etc. Figure 2 shows the setting interface after clicking the setting button in the upper right corner. You can configure the device name, shared device, basic device functionality, and other settings.

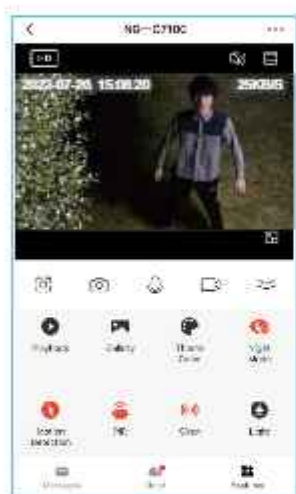

1



2

  
Full Screen

  
Taking

  
Intercom

  
Video

  
Function

  
Playback

  
Gallery

  
Theme Color

  
Night Mode

  
Motion Detection

  
PIR

  
Siren

  
Light

  
Working Mode

## 2. Detailed Setting of Main Interface Function:

### 2.1 ) Night Vision Mode Option

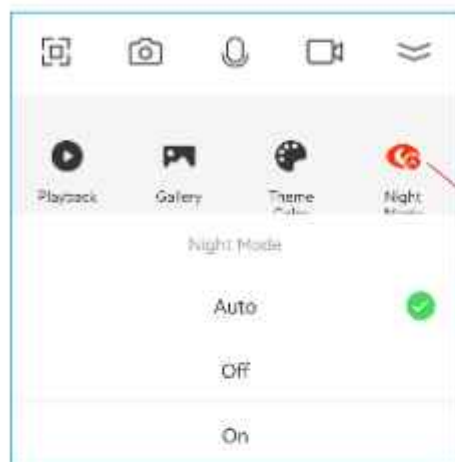

Night mode Auto / Off / On

### 2.2) PIR Sensor Sensitivity Setting

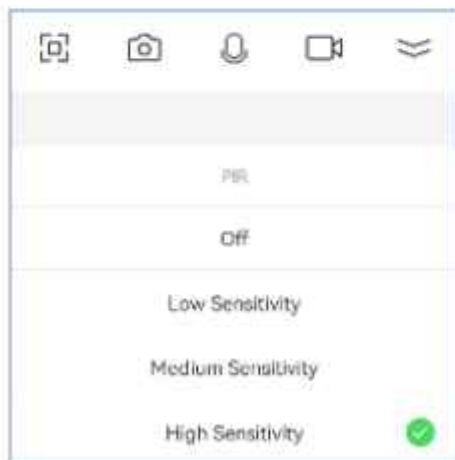

PIR option Off / Low sensitivity  
Medium sensitivity / High sensitivity

## 2.3) Light Option Setting

The screenshot displays the 'Light Control' interface. At the top, there are icons for camera, microphone, video, and a menu. Below these are four light icons. The 'Light' icon is highlighted with a callout box. The interface includes two sliders: 'Color Temperature Adjustment' (set to 100%) and 'Bright Adjustment' (set to 100%). Below the sliders are three buttons: 'Switch' (LED Light Switch), 'Time del...' (Time-delay duration set...), and 'Timing'. The 'Timing' button is linked to a table showing a schedule. The 'Time del...' button is linked to a 'Time-delay duration set...' dialog showing a slider set to 1.0s. The 'Switch' button is linked to an 'LED Light Switch' label.

Light

Color Temperature Adjustment

Bright Adjustment

LED Light Switch

Time-delay duration set...

1.0s

Action

Cancel	Add	Save
	08	18
	07	19
	08	20
	09	21
	10	22
	11	23
	12	24

Sun Mon Tue Wed Thur Fri Sat

Tag

Notification

Light Switch Open

The default lighting time is 15s, which can be overlaid to increase the lighting time for 1s-600s.

Turn on / off light regularly

## 2.4) Sensor Light on Option

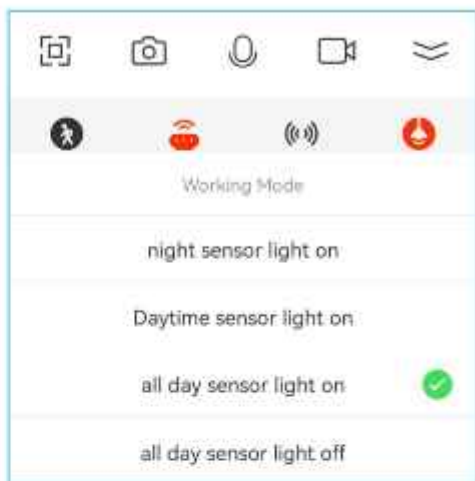
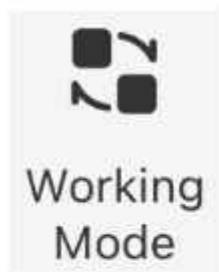

### 3. Setting Interface:

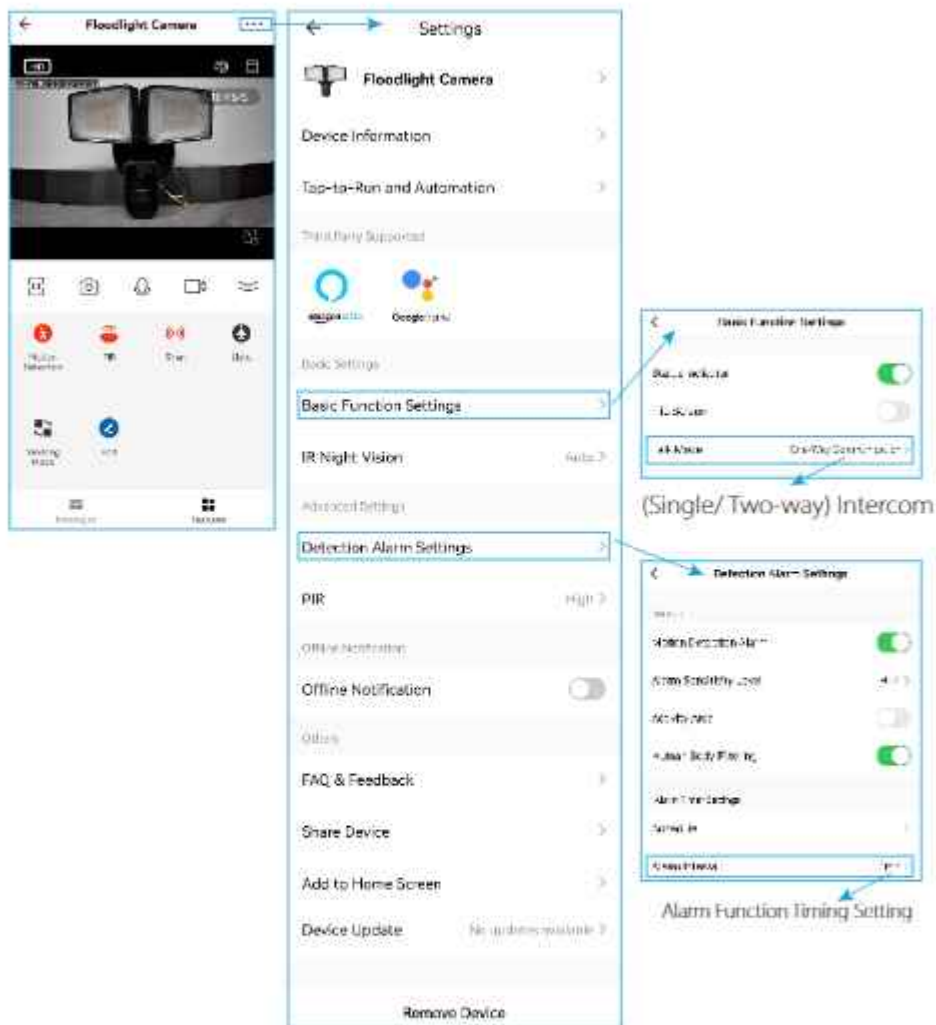

## 4. Alarm Function Setting Description:

### 4.1) PIR Sensor

PIR Infrared human body sensing, adjustable sensitivity (off / low / medium / high) The highest sensing distance is 8m, the sensing angle is 135 degrees, the light will on and an alert will sound when objects are detected moving, and the light only with PIR does not provide photography and background push messaging.

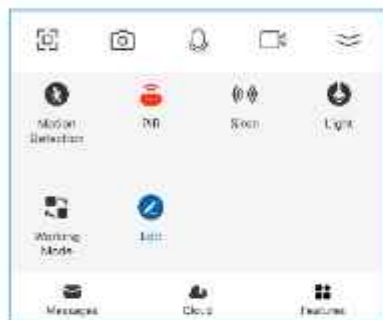

### 4.2) Motion Detection

Adjust the motion detection sensitivity (low / medium / high) three levels optionally, turn on the high sensitivity of motion detection + human body filtering, and the maximum sensing distance is 6m, that is, the camera detects the item moving and identifies that it is a person to take photos. Turn on the light and, in the background, push the photos to the user's mobile phone for real-time viewing. Motion detection occurs when the camera lens detects a moving object.

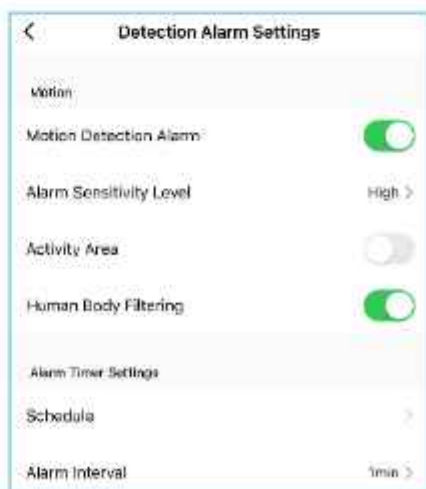
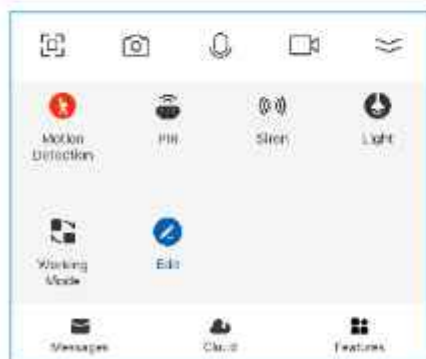



### 4.3) PIR+ Motion Detection

PIR + motion detection 2 in 1 sensing, that is, when they sense the movement of objects at the same time, they turn on the light, capture photos, and push them to the user's mobile phone in the background for real-time viewing. Two-in-one sensing can enhance detection accuracy and reduce false alarms.



### 4.4) PIR+ Motion Detection + Human Body Filtering

Human body filtering + PIR + Motion detection Three-in-one sensing refers to the technique wherein when a person enters the PIR area, the PIR first detects the item, activates the light and alarm, and then enters the camera. When the camera recognizes that it is a human, it takes a photo and sends it to the mobile device so that the user may view it. PIR and motion detection are realized separately by this function (human filtering).

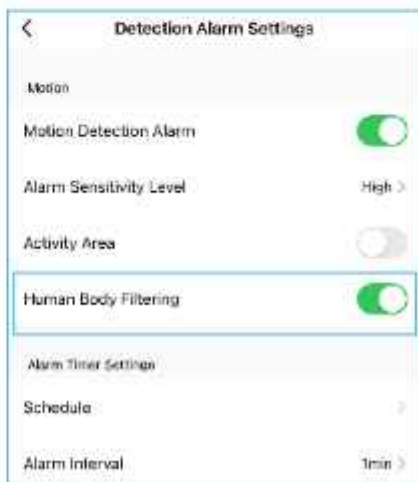
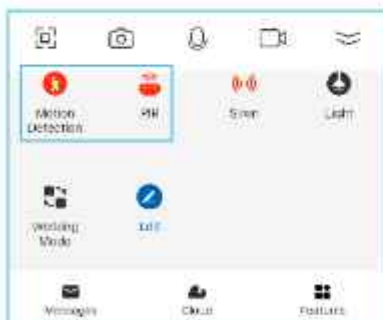

## 5. Third Party Voice Service (Only some functions are used):

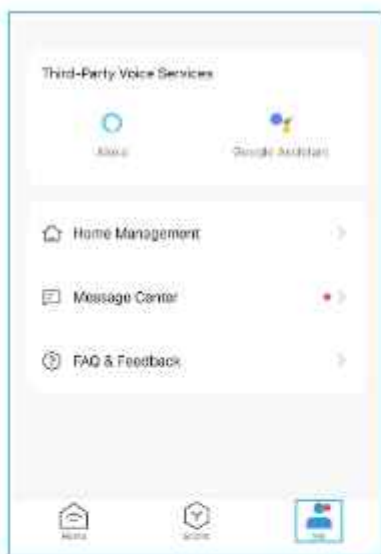

You can use Alexa and Google Assistant.

## 6. TF Card and Reset Button:



### Reset:

Press the card needle for 3-5s, and the factory setting will be restored after a beep sound.

### Micro SD:

A maximum 128G TF card can be loaded for playback of stored video.

## 7. Cloud Storage Service:

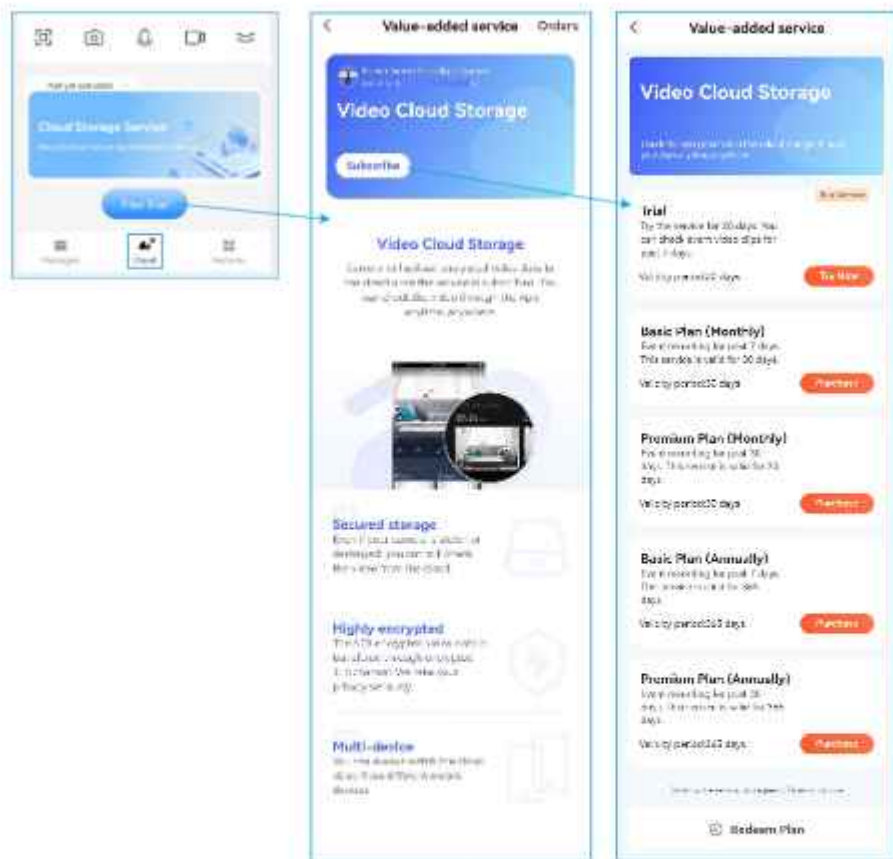

## FAQ

Q: How to share devices?

In the real-time video viewing interface, click the setting button in the upper right corner to enter the device setting interface, click "share device", then click "add sharing", enter the mobile phone number or email address of the user you want to share, and click "finish" to share successfully.

Q: How does the camera store videos?

At present, the camera supports EXFAT, FAT32 format, Class6 and class10. The TF card supports 128G at most. After the TF card is full, the earlier videos are automatically deleted and recorded circularly.

Q: How to check if the camera is abnormally offline?

1. Check whether the power supply and network are normal.
2. Restart the device.
3. Reconfigure the camera.
4. Check whether the network broadband at home is normal.

Q: How to switch network environment?

When using in a new network environment, please press and hold the reset hole at the back of the device with the thimble for about 3-5 seconds. When you hear the beep prompt tone, the reset is successful. Restart and connect the network configuration.

### Note:

App and equipment firmware will be updated from time to time. If there is any upgrade, please upgrade online without notice. The manual is for reference only.



## Warning:

This device complies with Part 15 of the FCC Rules. Operation is subject to the following two conditions: (1) This device may not cause harmful interference, and (2) this device must accept any interference received, including interference that may cause undesired operation.

This equipment has been tested and found to comply with the limits for a Class B digital device, pursuant to Part 15 of the FCC Rules. These limits are designed to provide reasonable protection against harmful interference in a residential installation. This equipment generates, uses, and can radiate radio frequency energy and, if not installed and used in accordance with the instructions, may cause harmful interference to radio communications. However, there is no guarantee that interference will not occur in a particular installation. If this equipment does cause harmful interference to radio or television reception, which can be determined by turning the equipment off and on, the user is encouraged to try to correct the interference by one or more of the following measures:

- Reorient or relocate the receiving antenna.
- Increase the separation between the equipment and receiver.
- Connect the equipment into an outlet on a circuit different from that to which the receiver is connected.
- Consult the dealer or an experienced radio/TV technician for help.

### FCC RF Radiation Exposure Statement:

- This Transmitter must not be co-located or operating in conjunction with any other antenna or transmitter.
- This equipment complies with RF radiation exposure limits set forth for an uncontrolled environment.

**IMPORTANT!** Any changes or modifications not expressly approved by the party responsible for compliance could void the user's authority to operate the equipment.

1600 Union Hill Road Alpharetta, GA 30005  
E-mail: [service.ng@ngteco.com](mailto:service.ng@ngteco.com)  
[www.ngteco.com](http://www.ngteco.com)



Copyright©2022 NGTECO CO., LIMITED. All rights reserved.